

Standard Series

LFP12100 12V100Ah

FirstPower®

Dimension(mm)

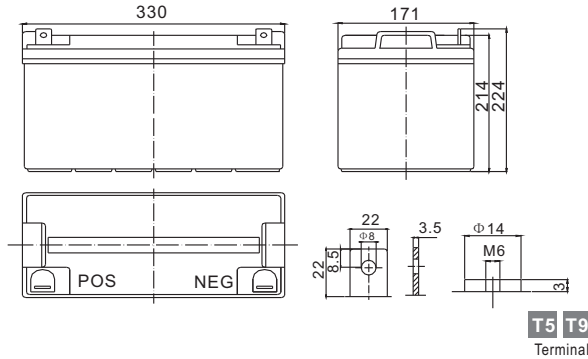

Specification

| | | |
|----------------------|---------------------|---------------------------------|
| Nominal Voltage | | 12 V |
| Capacity(10HR, 25°C) | | 100 Ah |
| Dimension | Length | 330mm (13.0inch) |
| | Width | 171mm (6.7inch) |
| | Height | 214mm (8.4inch) |
| | Total Height(T5/T9) | 224mm (8.8inch)/220mm (8.7inch) |
| Approx. Weight | | 30.5kg (67.1lbs) |

Characteristics

| | | |
|--|--------------|----------------------------|
| Capacity 20°C (68°F) To 1.70V/Cell | 20 hour rate | 107Ah |
| | 10 hour rate | 100Ah |
| | 5 hour rate | 91Ah |
| | 1 hour rate | 62.4Ah |
| | 15 min rate | 42Ah |
| Internal resistance(Fully charged, 25°C) | | Approx. 4.5mΩ |
| Capacity affected by temperature (10HR) | 40°C | 102% |
| | 25°C | 100% |
| | 0°C | 85% |
| | -15°C | 65% |
| Self-discharge (25°C) | 3 month | Remaining Capacity: 91% |
| | 6 month | Remaining Capacity: 82% |
| | 12 month | Remaining Capacity: 65% |
| Nominal operating temperature | | 25°C ± 3°C (77°F ± 5°F) |
| Operating temperature range | | -15°C ~ 50°C (5°F ~ 122°F) |
| Float charging voltage(25°C) | | 13.50 to 13.80V |
| Cyclic charging voltage(25°C) | | 14.50 to 14.90V |
| Maximum charging current | | 30A |
| Terminal material | | Copper |
| Maximum discharge current | | 800A(5 Sec.) |

The Relationship for Open Circuit Voltage and Residual Capacity (25°C)

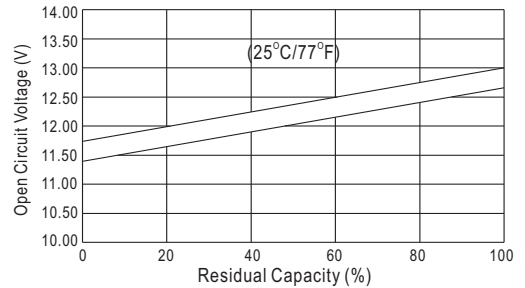

Charging Characteristics(25°C)

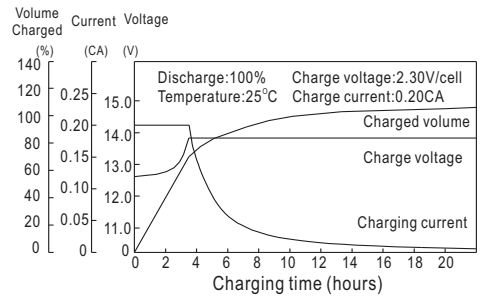

Cycle Life(25°C)

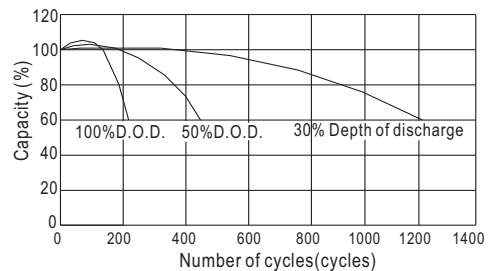

Constant Current Discharge Characteristics (A, 25°C)

| F.V/TIME | 5min | 10min | 15min | 30min | 60min | 3h | 5h | 10h | 20h |
|----------|------|-------|-------|-------|-------|------|------|------|------|
| 9.60V | 320 | 220 | 175 | 108 | 65.0 | 26.4 | 18.5 | 10.3 | 5.35 |
| 10.2V | 304 | 209 | 168 | 104 | 62.4 | 26.0 | 18.2 | 10.2 | 5.35 |
| 10.8V | 286 | 196 | 160 | 98.8 | 59.3 | 25.5 | 17.8 | 10.0 | 5.30 |

Constant Power Discharge Characteristics (Watt, 25°C)

| 5min | 10min | 15min | 30min | 60min | 3h | 5h | 10h | 20h |
|------|-------|-------|-------|-------|-----|-----|-----|------|
| 3360 | 2376 | 1922 | 1212 | 741 | 310 | 219 | 123 | 64.2 |
| 3192 | 2257 | 1845 | 1167 | 711 | 306 | 215 | 122 | 64.2 |
| 3003 | 2117 | 1757 | 1109 | 676 | 300 | 210 | 119 | 63.6 |