

# Standard Series

# LFP12145

12V145Ah

**FirstPower®**

## Dimension

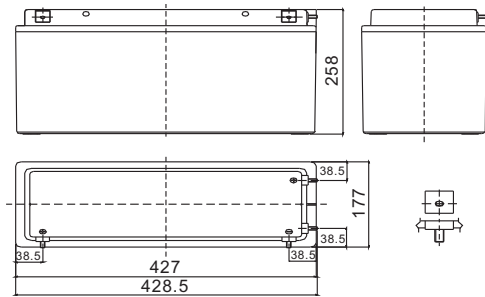

M6 bolt  
Terminal

## Specification

Nominal Voltage		12 V
Capacity(10HR, 25°C)		145 Ah
Dimension	Length	428.5mm (16.9inch)
	Width	177mm (7.0inch)
	Height	258mm (10.2inch)
	Total Height	258mm (10.2inch)
Approx. Weight		47.5kg (104.7lbs)

## Characteristics

Capacity 20°C (68°F) To 1.70V/Cell	20 hour rate	153.2Ah
	10 hour rate	145Ah
	5 hour rate	130.5Ah
	1 hour rate	87.7Ah
	15 min rate	57.5Ah
Internal resistance(Fully charged, 25°C)		Approx 4.5mΩ
Capacity affected by temperature (10HR)	40°C	102%
	25°C	100%
	0°C	85%
	-15°C	65%
Self-discharge (25°C)	3 month	Remaining Capacity: 91%
	6 month	Remaining Capacity: 82%
	12 month	Remaining Capacity: 65%
Nominal operating temperature		25°C ±3°C(77°F ±5°F)
Operating temperature range		-15°C~50°C(5°F~122°F)
Float charging voltage(25°C)		13.50 to 13.80V
Cyclic charging voltage(25°C)		14.50 to 14.90V
Maximum charging current		43.5A
Terminal material		Stainless steel
Maximum discharge current		1000A(5 Sec.)

## The Relationship for Open Circuit Voltage and Residual Capacity (25°C)

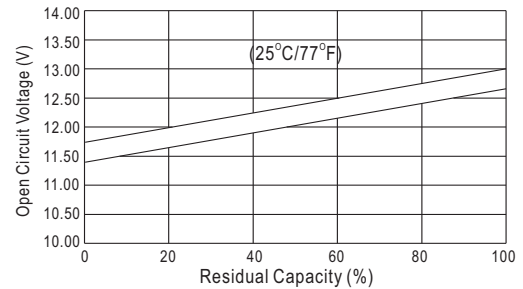

## Charging Characteristics(25°C)

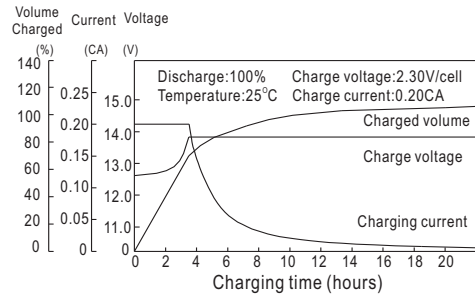

## Cycle Life(25°C)

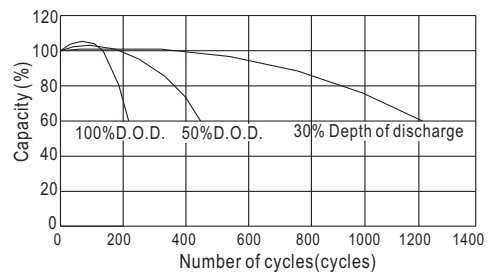

## Constant Current Discharge Characteristics (A, 25°C)

F.V/TIME	5min	10min	15min	30min	60min	3h	5h	10h	20h
9.60V	--	--	239	151	91.4	37.5	26.5	14.7	7.73
10.2V	--	--	230	145	87.7	37.0	26.1	14.6	7.66
10.8V	--	--	218	138	83.3	36.2	25.6	14.5	7.61

## Constant Power Discharge Characteristics (Watt, 25°C)

	5min	10min	15min	30min	60min	3h	5h	10h	20h
	--	--	2627	1692	1041	441	313	176	92.7
	--	--	2522	1624	1000	435	309	174	91.9
	--	--	2396	1543	950	426	302	174	91.4